

WEST SUSSEX COUNTY COUNCIL
(CRAWLEY BOROUGH)
(PARKING PLACES AND TRAFFIC REGULATION)
(CONSOLIDATION) ORDER 2010)
(BALCOMBE ROAD AMENDMENT) ORDER 2014

CRAWLEY BOROUGH: LOCATION OF WAITING RESTRICTIONS

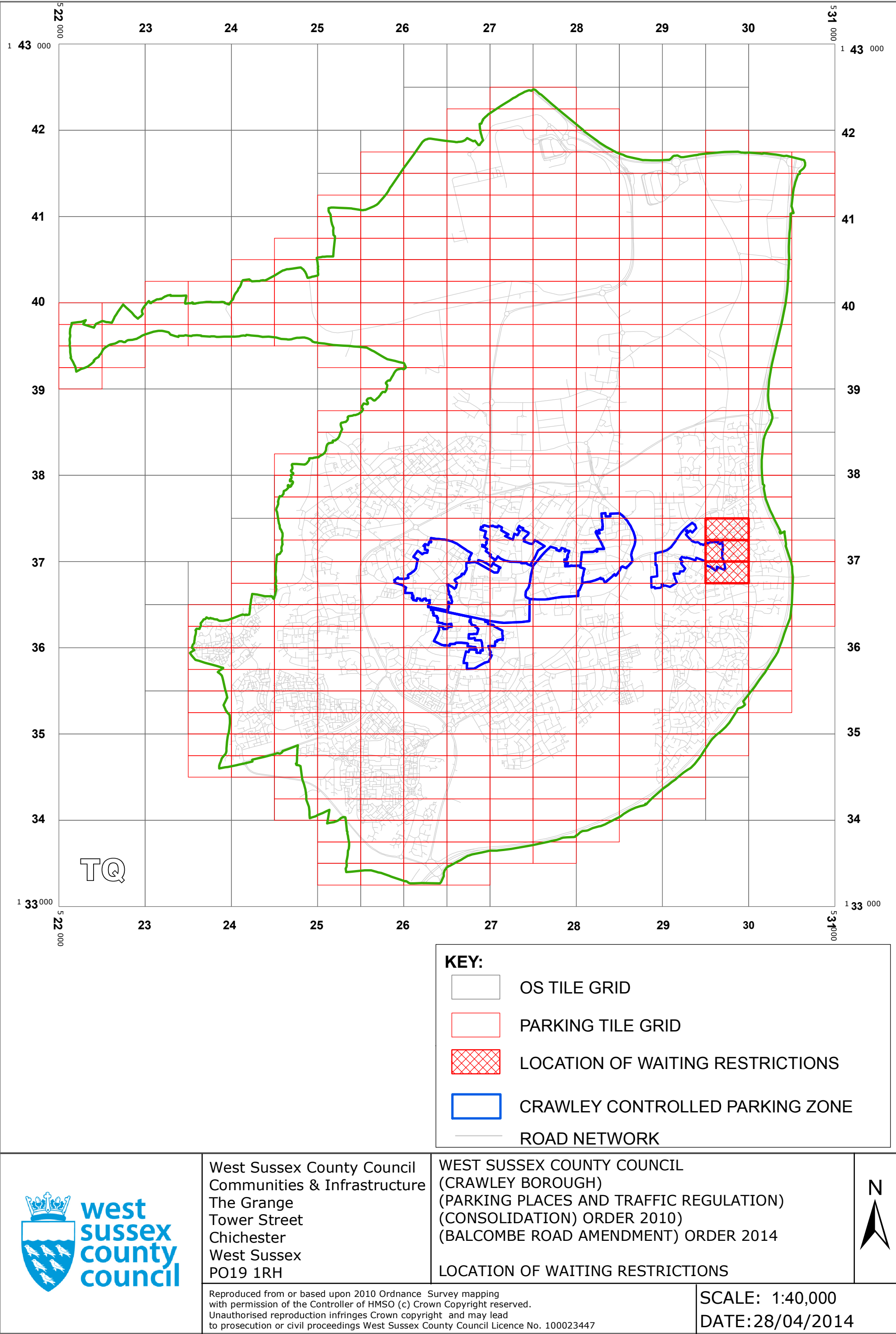

Key for Waiting Restrictions

All areas over which the provision of the orders apply are defined by the shaded areas as shown on the following plans plus a contiguous area not indicated on the plans of verge and/or footway between the carriageway edge and the highway boundary. The plans in this schedule are based upon grid references of the Ordnance Survey National Grid defined by the OSGB 36 triangulation.

Prohibition of waiting at any time

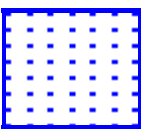
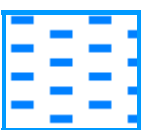
| | | | |
|-----|---|--------|---|
| 101 |  | check | No waiting at any time |
| 112 |  | dot5 | No waiting 8.00am-6.00pm Mon-Fri |
| 161 |  | pat063 | No waiting 9:00am-5:00pm Mon-Fri except bank holidays |

Residents Parking

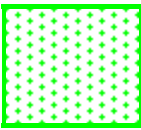
| | | | |
|-----|---|---------|--|
| 516 |  | usgs721 | Residents' and Visitors' permit holders only 9.00am-5.00pm Mon-Fri except bank holidays |
|-----|---|---------|--|

 Boundary of Controlled Parking Zone

5842

1. This Order shall come into operation on the 28th day of April 2014 and may be cited as "West Sussex County Council ((Crawley Borough) (Parking Places and Traffic Regulation) (Consolidation) Order 2010) (Balcombe Road Amendment) Order 2014."
2. The "West Sussex County Council (Crawley Borough) (Parking Places and Traffic Regulation) (Consolidation) Order 2010" is hereby amended by the deletion from it of the plans specified in the First Schedule to this Order and the substitution of the plans attached in the Second Schedule to this Order and, the insertion into it of the plan attached in the Third Schedule to this Order.

- 1 -

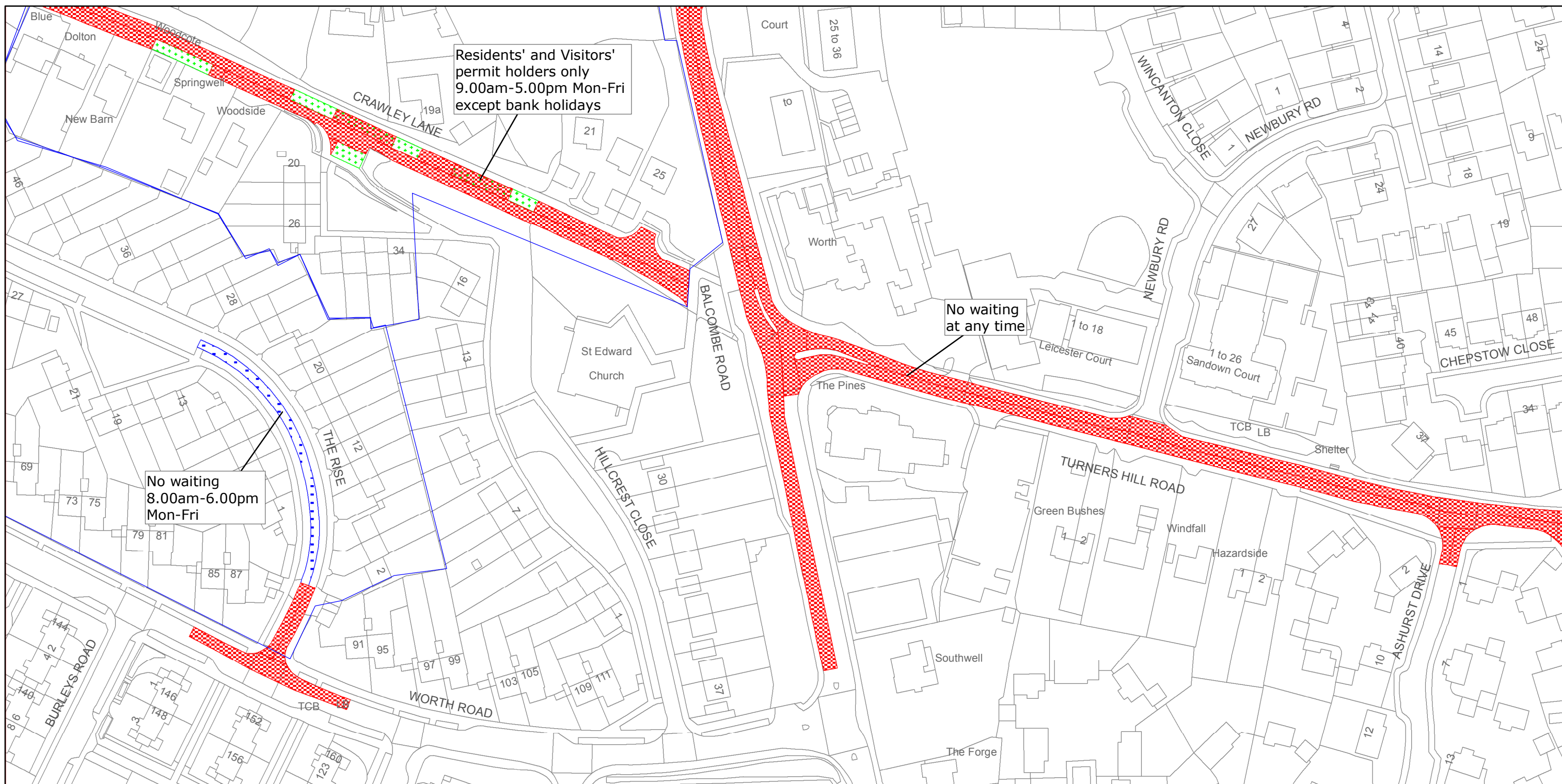

West Sussex County Council
Highways & Transport
The Grange
Tower Street
Chichester
West Sussex
PO19 1RH

CRAWLEY BOROUGH: POUND HILL SOUTH AND WORTH WARD

WAITING RESTRICTIONS

Reproduced from or based upon 2010 Ordnance Survey mapping with permission of the Controller of HMSO (c) Crown Copyright reserved.
Unauthorised reproduction infringes Crown copyright and may lead to prosecution or civil proceedings West Sussex County Council Licence No. 100018485

TILE REF NO:
TQ2936NEN

SHEET ISSUE NO 4
SHEET ACTIVE FROM - 28/04/2014



SCALE:
1:1250
at A3 size

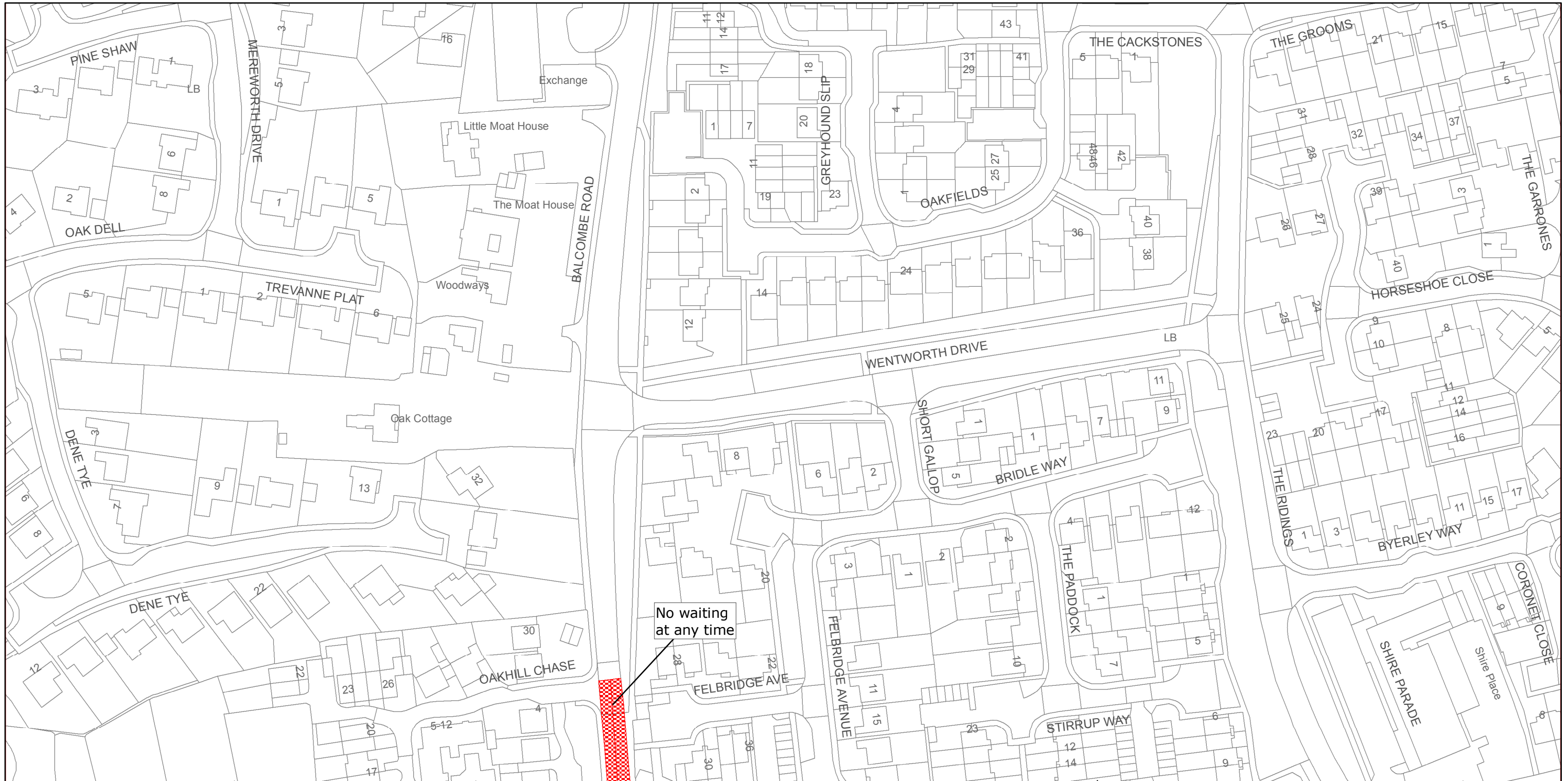

West Sussex County Council
Highways & Transport
The Grange
Tower Street
Chichester
West Sussex
PO19 1RH

CRAWLEY BOROUGH: POUND HILL SOUTH
AND WORTH WARD

WAITING RESTRICTIONS

Reproduced from or based upon 2010 Ordnance Survey mapping with permission of the Controller of HMSO (c) Crown Copyright reserved.
Unauthorised reproduction infringes Crown copyright and may lead to prosecution or civil proceedings West Sussex County Council Licence No. 100018485

TILE REF NO:
TQ2937SEN

SHEET ISSUE NO 1
SHEET ACTIVE FROM - 28/04/2014



SCALE:
1:1250
at A3 size

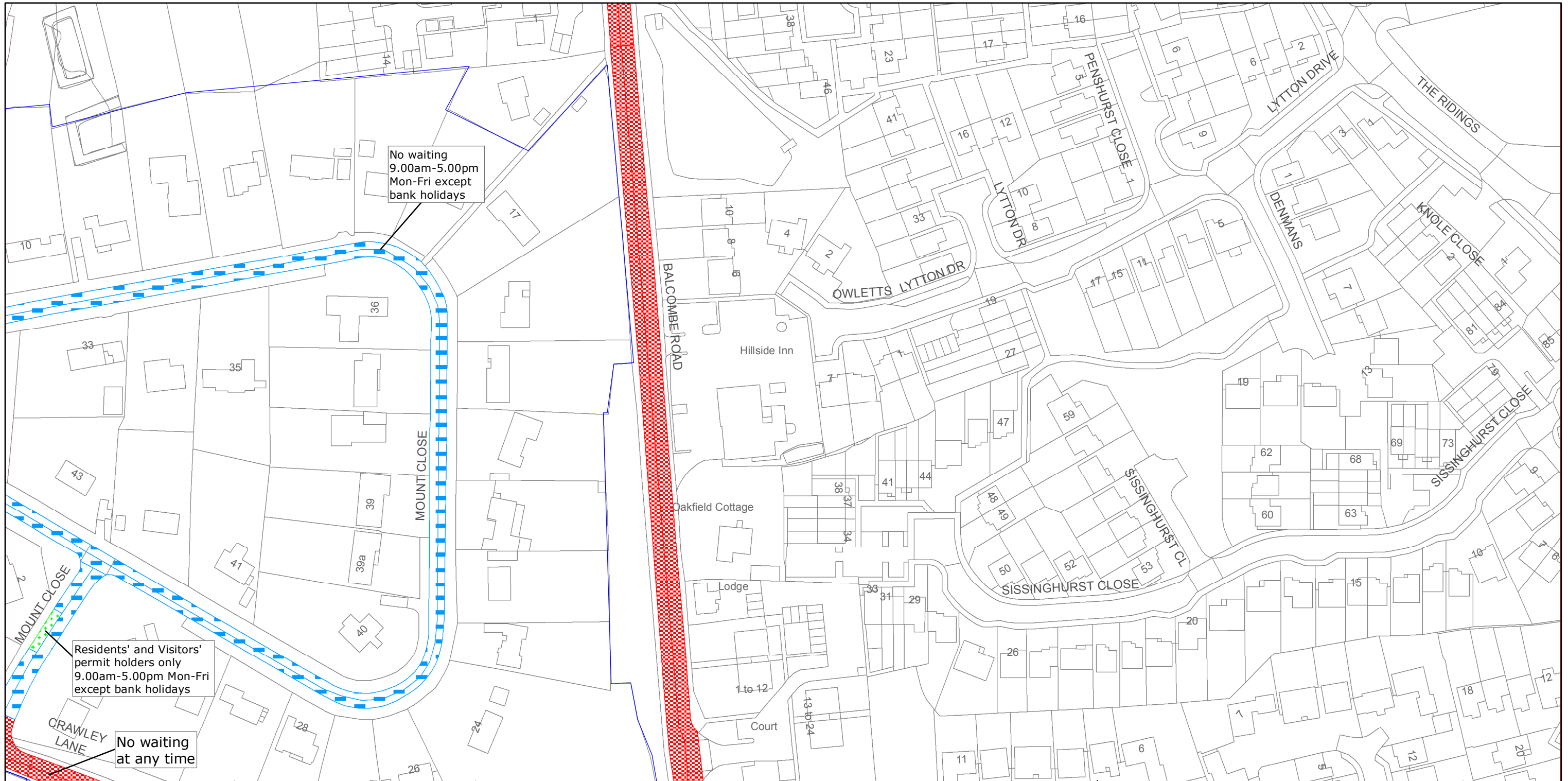

West Sussex County Council
Highways & Transport
The Grange
Tower Street
Chichester
West Sussex
PO19 1RH

CRAWLEY BOROUGH: POUND HILL SOUTH AND WORTH WARD

WAITING RESTRICTIONS

Reproduced from or based upon 2010 Ordnance Survey mapping with permission of the Controller of HMSO (c) Crown Copyright reserved.
Unauthorised reproduction infringes Crown copyright and may lead to prosecution or civil proceedings West Sussex County Council Licence No. 100018485

TILE REF NO:
TQ2937SES

SHEET ISSUE NO 3
SHEET ACTIVE FROM - 28/04/2014



SCALE:
1:1250
at A3 size